

Hole Plugs - Locking

Multiple locks to snap positively into panel thickness from 0.8mm to 3.2mm

Molded in Black Heat Stabilised Nylon – UV Resistant

Natural, white and grey available in some sizes.

Part Number	Panel Hole Diameter	Max. Panel Thickness	Head Diameter B	Depth C
22-PPL05	4.8	1.6	6.4	5.9
22-PPL06	6.3	1.6	8.0	8.0
22-PPL08	8.0	1.6	9.5	8.0
22-PPL09	9.5	3.2	12.0	10.3
22-PPL11	11.0	3.2	13.5	10.3
22-PPL13	12.7	3.2	14.6	10.3
22-PPL14	14.3	3.2	16.7	10.3
22-PPL16	15.9	3.2	18.2	10.3
22-PPL17	17.5	3.2	20	10.3
22-PPL19	19.1	3.2	23.2	10.3
22-PPL20	20.6	3.2	22.6	10.3
22-PPL22	22.2	3.2	25.8	11.5
22-PPL25	25.4	3.2	30.5	11.5
22-PPL28	28.0	3.2	31.0	11.5
22-PPL30	30.1	3.2	33.3	11.5
22-PPL32	32.0	3.2	34.9	11.5
22-PPL35	35.0	3.2	38.0	11.5
22-PPL38	38.0	3.2	42.7	11.5
22-PPL45	45.0	3.2	48.9	11.5
22-PPL51	51.0	3.2	55.0	11.5

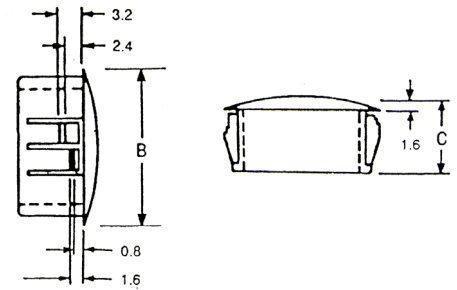

N = Natural OP = Grey W = White No Suffix = Black
 eg. 22-PPL05W = White 22-PPL05= Black

Pipe Plugs - Slotted Threaded

To fit NPT Sizes • Protect valves, hydraulic and pneumatic devices from contamination • Nylon 6/6

Grub Style drive allows installation and removal with a common screw driver

Part Number	Description	A	B	C	L
22-NPT1/8-27	1/8-27 NPT Pipe Thread Plug	1.83	6.10	3.30	9.91
22-NPT1/4-18	1/4-18 NPT Pipe Thread Plug	1.83	7.92	3.30	12.70
22-NPT3/8-18	3/8-18 NPT Pipe Thread Plug	3.81	9.10	9.65	13.97
22-NPT1/2-14	1/2-14 NPT Pipe Thread Plug N PT	3.81	11.89	9.27	14.35
22-NPT3/4-14	3/4-14 NPT Pipe Thread plug	4.44	13.97	11.05	15.49

